

# Steeles Avenue East Road Works South Side - Kennedy Road to Redlea Avenue

September 27, 2021

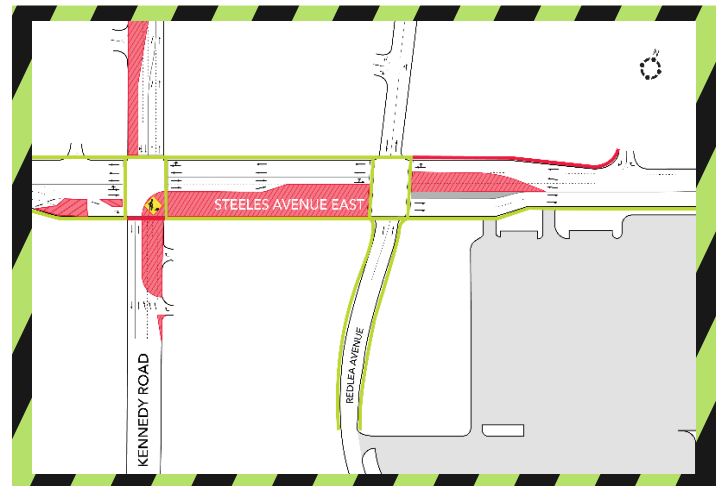
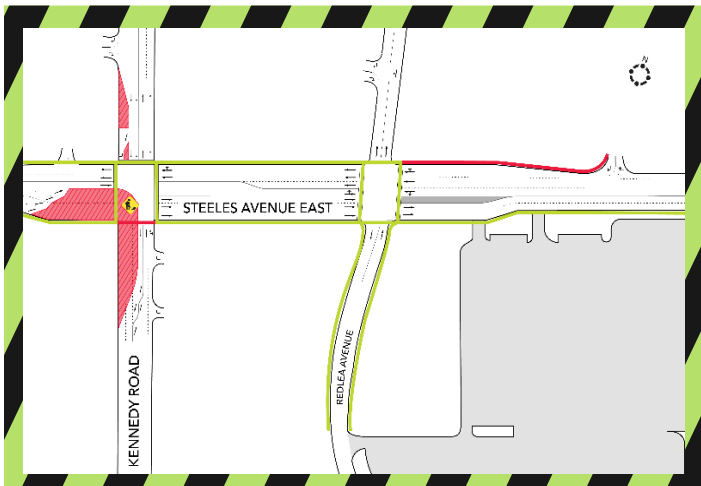
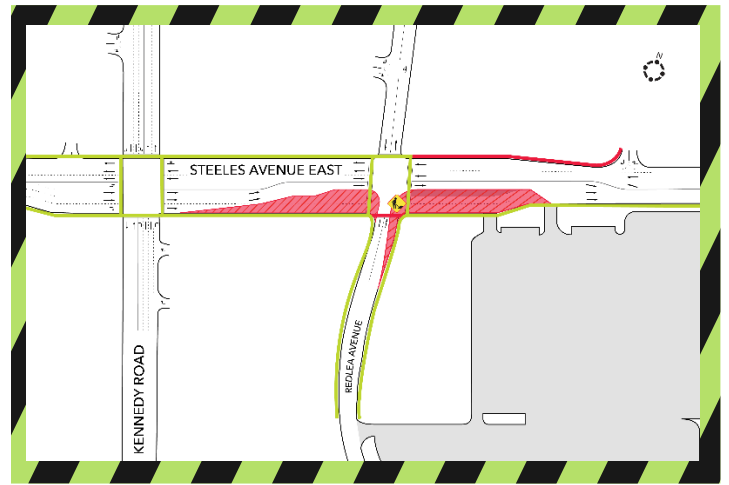
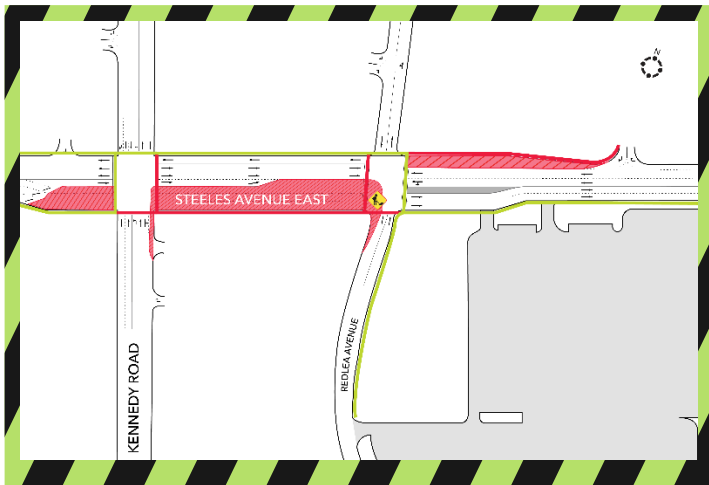

Visit our Community Office: Currently closed due to COVID-19  
Address: 4142 Sheppard Avenue East  
Tel: 416-202-3900

**Contact Us:**  
Write to us at: [TorontoEast@metrolinx.com](mailto:TorontoEast@metrolinx.com)  
Find us on Twitter @GOExpansion  
Visit the website: [www.metrolinx.com](http://www.metrolinx.com)  
Disponible en français

## WHAT IS HAPPENING?

As part of the continued construction at the Steeles Avenue East underpass, the contractor will be performing road reconstruction works on the south side of Steeles Avenue East west of Kennedy Road to east of Redlea Avenue. Crews will be working at the southeast and southwest corner of the Steeles Avenue East and Redlea Avenue intersection followed by the southeast and southwest corners of the Steeles Avenue East and Kennedy Road intersection. Work is expected to begin as early as September 27 and continue for approximately three (3) weeks.

## WHAT TO EXPECT

Construction vehicles and equipment will occupy the designated work zone on the south side of Steeles Avenue East, some noise can be expected from crews working in the area. Crosswalk, sidewalk, and curb lane closures will be required to complete these works safely (depicted above). Directional signage will be installed to direct pedestrians to available routes.

## HOURS OF WORK

- Work will begin as early as September 27, 2021 and continue for approximately three (3) weeks.
- Work is scheduled to take place Monday – Friday between the hours of 6:00 a.m. and 5:00 p.m.
- Occasional weekend and overnight work may be required.
- This work may be delayed or rescheduled due to inclement weather or unforeseen circumstances.

## TRAFFIC & PEDESTRIAN DETAILS

- Closure of the eastbound curb lanes east of Redlea Avenue to west of Kennedy Road will be implemented.
- The south east to west crosswalk at Kennedy Road or Redlea Avenue will be closed.
- The north sidewalk on Steeles Avenue East, east of Redlea Avenue will remain closed through to mid-2022 for grade separation works. The south sidewalk on Steeles Avenue East will remain available east of Redlea Avenue.
- Pedestrian access to Milliken GO Station will remain available via Redlea Avenue (south of Steeles Avenue East).

## TRANSIT INFORMATION

- TTC busses will remain operational. For more information about bus service and stop locations please visit [ttc.ca](http://ttc.ca)

## OTHER INFORMATION

- For the latest information on what's happening in your area, please e-mail us at [TorontoEast@Metrolinx.com](mailto:TorontoEast@Metrolinx.com) and ask to subscribe to our weekly e-newsletter.

Thank you for your patience while we improve transit to get communities moving.

All dates are subject to change and will be communicated accordingly.

Visit our Community Office: Currently closed due to COVID-19  
Address: 4142 Sheppard Avenue East  
Tel: 416-202-3900

---

### Contact Us:

Write to us at: [TorontoEast@metrolinx.com](mailto:TorontoEast@metrolinx.com)

Find us on Twitter @GOExpansion

Visit the website: [www.metrolinx.com](http://www.metrolinx.com)

Disponible en français