

# Steeles Avenue East Weekend Closure

Between Redlea Avenue and Midland Avenue

April 30 – May 3 2021

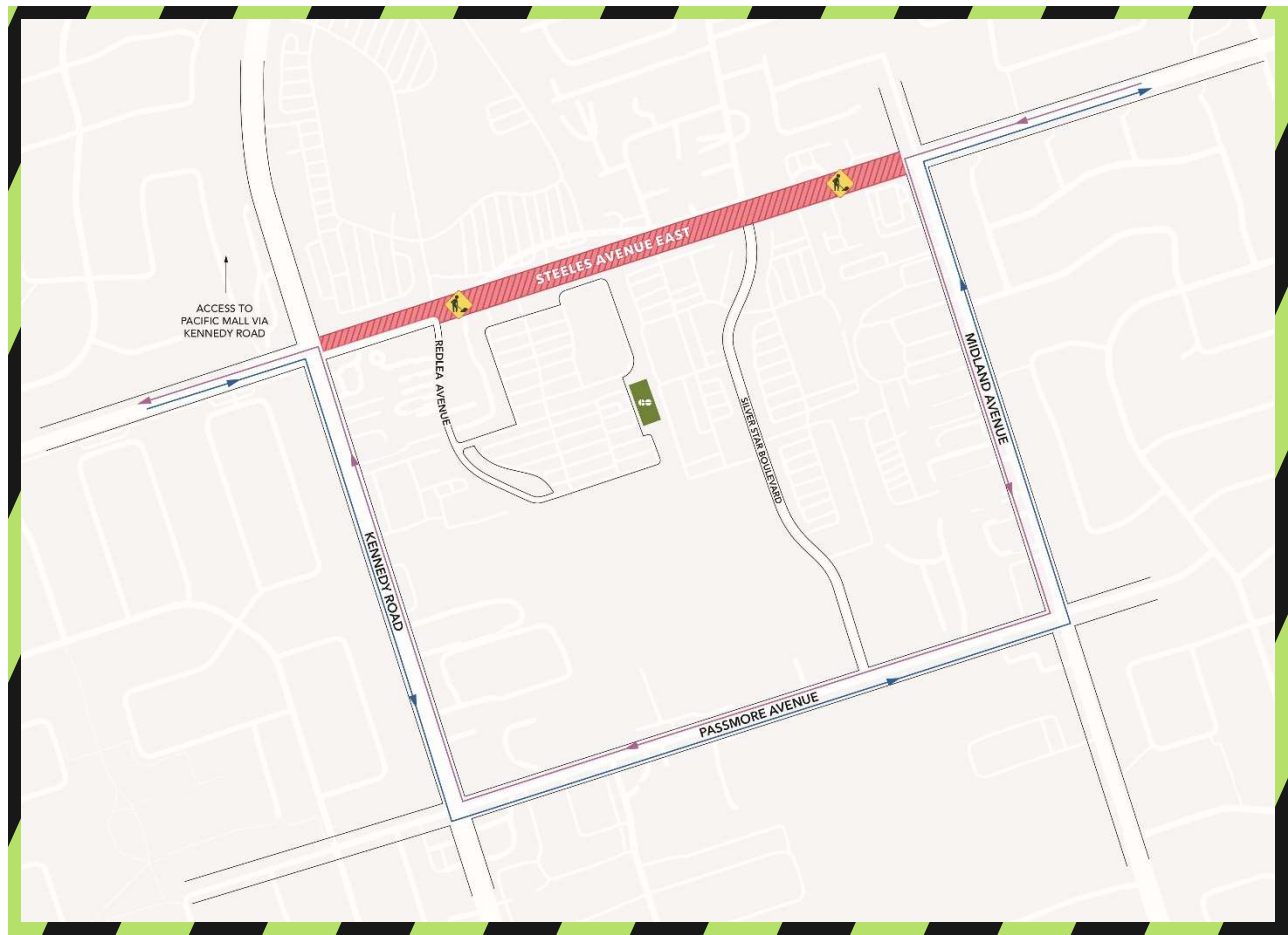

## What is Happening?

There will be a full road closure of Steeles Avenue East between Redlea Avenue and Midland Avenue. The closure will allow crews to prepare for the next traffic configuration and divert traffic safely to the south side of the new underpass, below the rail bridge. During the weekend closure, traffic delays are expected. Detour routes will be clearly signed for drivers and pedestrians.

Visit our Community Office: Currently closed due to COVID-19  
Address: 4142 Sheppard Avenue East  
Tel: 416-202-3900

**Contact Us:**  
Write to us at: [TorontoEast@metrolinx.com](mailto:TorontoEast@metrolinx.com)  
Find us on Twitter @GOExpansion  
Visit the website: [www.metrolinx.com](http://www.metrolinx.com)  
Disponible en français

## What to Expect?

From 8:00 p.m. on Friday April 30 to 6:00 a.m. on Monday May 3, 2021 there will be no vehicle or pedestrian access on Steeles Avenue East between Redlea Avenue and Midland Avenue. For the duration of the road closure, construction will take place during the day and overnight. Crews will be performing road tie-ins, paving activities, constructing curbs, line painting and installing temporary construction barriers for the new traffic staging.

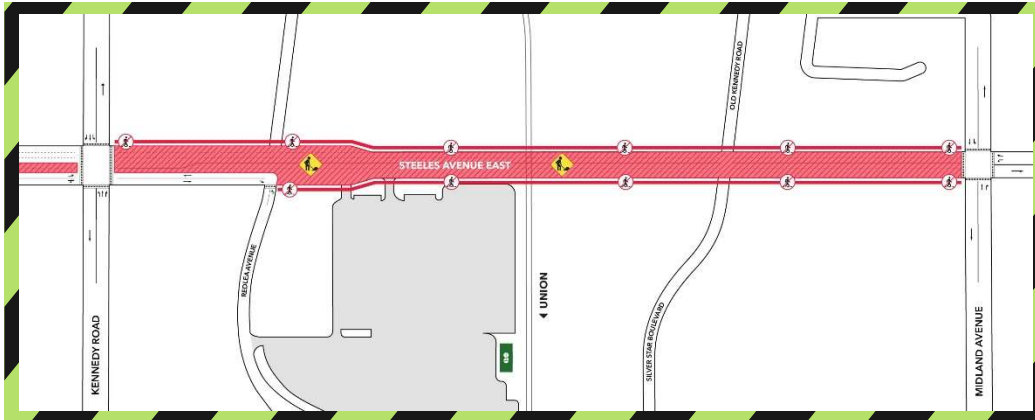

## HOURS OF WORK

- The road closure and associated works will take place Friday, April 30 at 8:00 p.m. through to 6:00 a.m. on Monday May 3, 2021.
- Contractors will be working during the day and overnight for the period of the road closure.
- Work may be delayed or rescheduled due to inclement weather or unforeseen circumstances.

## TRAFFIC & PEDESTRIAN DETAILS

- There will be no vehicle or pedestrian access on Steeles Avenue East between Redlea Avenue and Old Kennedy Road/Silver Star Boulevard.
  - Eastbound traffic will be directed south on Kennedy Road to Passmore Avenue and north on Midland Avenue.
  - Westbound traffic will be directed south on Midland Avenue to Passmore Avenue and north on Kennedy Road.
  - One lane in each direction will be maintained between Kennedy Road and Redlea Avenue to provide access to businesses located south of Steeles Avenue East along Redlea Avenue.

## TRANSIT INFORMATION

- TTC busses will be operational using the detour route. For more information about bus service please visit [ttc.ca](http://ttc.ca)

## OTHER INFORMATION

- For the latest information on what's happening in your area, please e-mail us at [TorontoEast@Metrolinx.com](mailto:TorontoEast@Metrolinx.com) and ask to subscribe to our weekly e-newsletter.

Thank you for your patience while we improve transit to get communities moving.  
All dates are subject to change and will be communicated accordingly.

Visit our Community Office: Currently closed due to COVID-19  
Address: 4142 Sheppard Avenue East  
Tel: 416-202-3900

## Contact Us:

Write to us at: [TorontoEast@metrolinx.com](mailto:TorontoEast@metrolinx.com)  
Find us on Twitter @GOExpansion  
Visit the website: [www.metrolinx.com](http://www.metrolinx.com)  
Disponible en français