

Signal Conduit Work Under the Sheppard Avenue East Rail Bridge

May 25, 2021

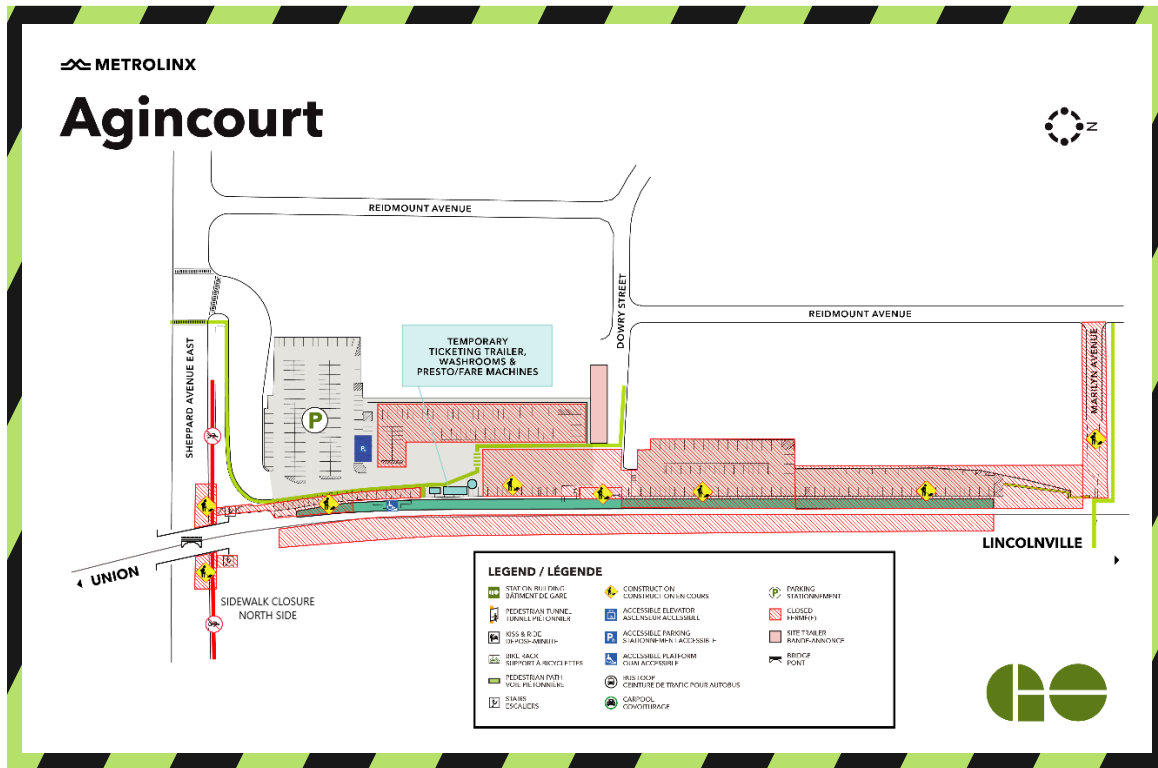

(Signal conduit installation on the north side of Sheppard Avenue East)

What is Happening?

As early as May 25, 2021, crews will begin installing brackets and signal conduits under the Sheppard Avenue East rail bridge. Work will take place in stages, beginning on the north side of Sheppard Avenue East for approximately one week followed by the south side works for approximately one week. To perform these activities safely, temporary lane closures and a pedestrian detour will be implemented.

What to Expect

Crews will erect a working platform under the bridge. While work takes place on the north side of Sheppard Avenue East, the north sidewalk will be closed and pedestrians directed to the available south sidewalk. When work begins on the south side of Sheppard Avenue East, the south sidewalk will close and pedestrians will be directed to the available

Visit our Agincourt Community Office: Currently closed due to COVID-19
 Address: 4142 Sheppard Avenue East
 Tel: 416-202-3900

Contact Us:
 Write to us at: TorontoEast@metrolinx.com
 Find us on Twitter @GOExpansion
 Visit the website: www.metrolinx.com
 Disponible en français

north sidewalk. Pedestrians are encouraged to use signalized north south crosswalks at the station entrance or at Lamont Avenue. Wayfinding signage will be installed directing pedestrians to available routes.

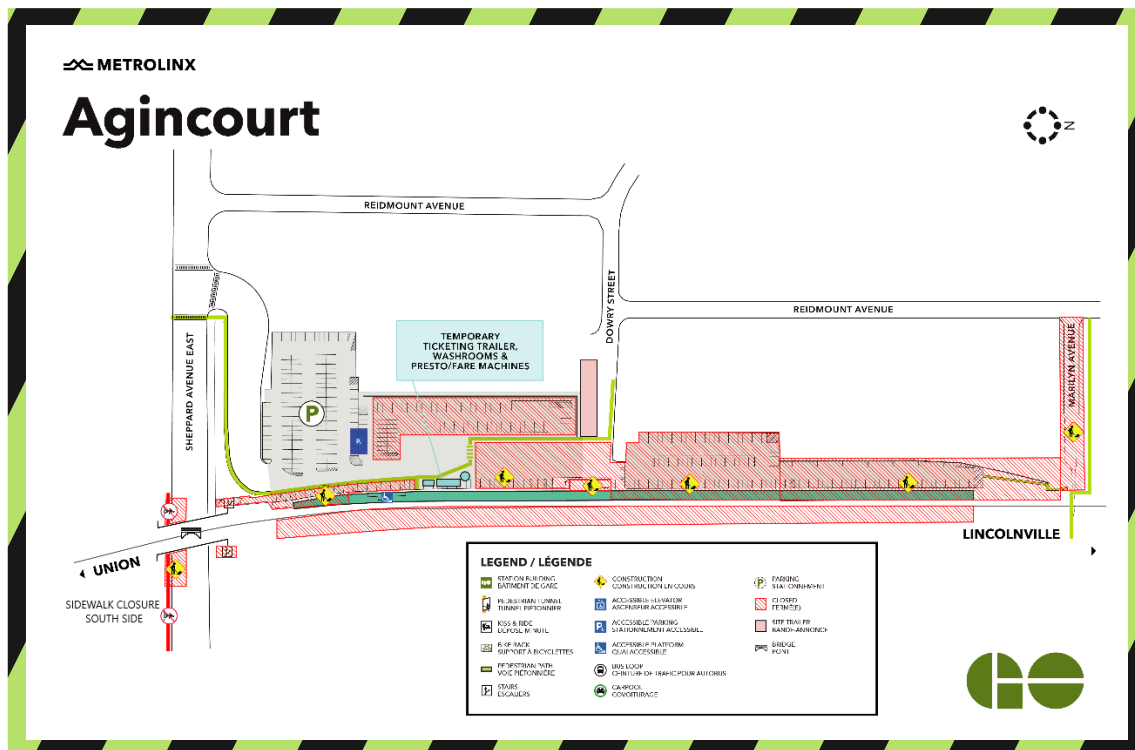

(Signal conduit installation on the south side of Sheppard Avenue East)

HOURS OF WORK

- Work is expected to begin as early as May 25, 2021 and continue for approximately two weeks.
- Work will take place Monday - Friday between the hours of 7:00 a.m. - 7:00 p.m.
- **Work may be rescheduled or extended due to weather conditions or unforeseen circumstances.**

TRAFFIC & PEDESTRIAN DETAILS

- The sidewalk on the north side of Sheppard Avenue East at Agincourt Station will be closed May 25, 2021 for approximately one week.
- The sidewalk on the south side of Sheppard Avenue East at Agincourt Station will be closed June 1, 2021 for approximately one week.
- Temporary lane closures will be implemented on Sheppard Avenue east to accommodate these construction activities. One lane in each direction will be maintained at all times.

TRANSIT INFORMATION

- No impacts to TTC, or other public transit modes are anticipated during this work.

Visit our Agincourt Community Office: Currently closed due to COVID-19
 Address: 4142 Sheppard Avenue East
 Tel: 416-202-3900

Contact Us:
 Write to us at: TorontoEast@metrolinx.com
 Find us on Twitter @GOExpansion
 Visit the website: www.metrolinx.com
 Disponible en français

OTHER INFORMATION

- For the latest information on what's happening in your area, please e-mail us at TorontoEast@Metrolinx.com and ask to subscribe to our weekly e-newsletter.

Thank you for your patience while we improve transit to get communities moving.

Visit our Agincourt Community Office: Currently closed due to COVID-19
Address: 4142 Sheppard Avenue East
Tel: 416-202-3900

Contact Us:
Write to us at: TorontoEast@metrolinx.com
Find us on Twitter @GOExpansion
Visit the website: www.metrolinx.com
Disponible en français