

# Rutherford Road Closure - East Diversion Track Activation

March 26-29, 2021

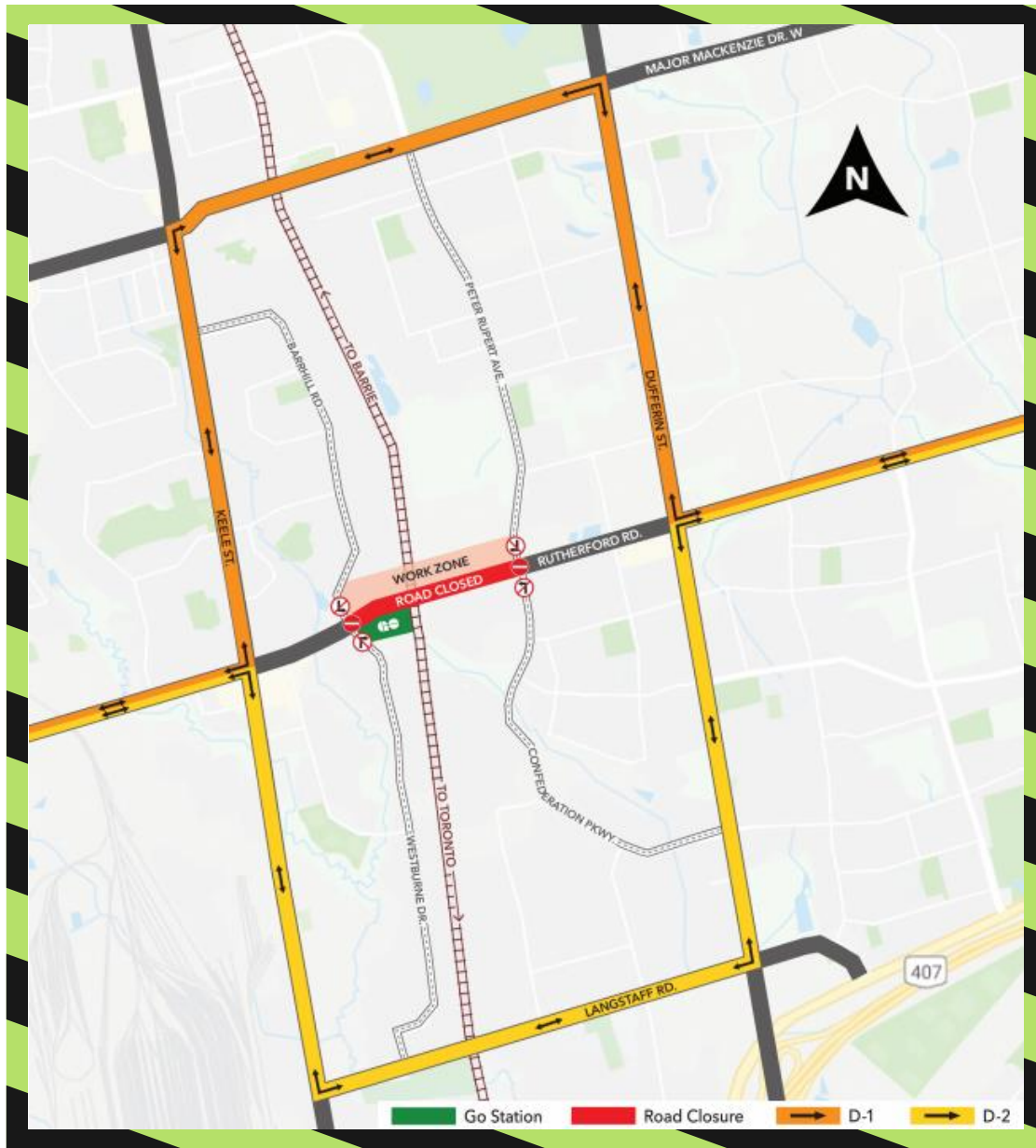

Contact Us:  
Write to us at: [YorkRegion@metrolinx.com](mailto:YorkRegion@metrolinx.com)  
Find us on Twitter @Metrolinx  
Visit the website: [www.metrolinx.com/rutherford](http://www.metrolinx.com/rutherford)  
Disponible en français

## The local project

Metrolinx contractors continue work on a new 6-storey parking structure with 1,200 net-new spaces and a new integrated station building at Rutherford GO Station.

## Construction Details

Crews will be performing roadworks at the Rutherford Road track crossing March 26 - 29, 2021. Asphalt removal will be required to stabilize and prepare the east track diversion for service. The diversion will allow construction to continue on the west half of the rail-over-road grade separation.

## What this means for you

A full road closure is required to complete these works in a safe and efficient manner. There will be no vehicular or pedestrian access on Rutherford Road between Westburne Drive and Peter Rupert Avenue and no GO train service from March 26 to March 29, 2021. Crews will be working daytime and overnight hours for the duration of the closure. Some noise from construction vehicles, equipment and crews can be expected. The contractor will work to carry out more disruptive work in the daytime hours whenever possible. Site lighting will be directed away from residential properties.

## HOURS OF WORK AND ROAD CLOSURE

- The road closure and associated works will take place Friday, March 26 at 7:00 p.m. through to 4:00 a.m. on Monday, March 29, 2021.
- Contractors will be working during the day and overnight for the period of the road closure.
- Work may be rescheduled due to weather conditions or unforeseen circumstances.

## TRAFFIC & PEDESTRIAN DETAILS

- There will be no vehicle or pedestrian access on Rutherford Road between Westburne Drive and Peter Rupert Avenue.
  - Traffic heading east on Rutherford Road will need to detour north or south onto Keele Street.
  - Traffic heading west on Rutherford Road will need to detour north or south onto Dufferin Street.
  - There will be no pedestrian access on Rutherford Road within the limits of the closure.

## TRANSIT INFORMATION

- There will be no GO train service for the duration of the road closure.
- GO and York Region buses will be operational using a detour route.

## OTHER INFORMATION

- For the latest information on what's happening in your area, please e-mail us at [YorkRegion@Metrolinx.com](mailto:YorkRegion@Metrolinx.com) or subscribe to our weekly e-newsletter at [metrolinx.com/rutherford](http://metrolinx.com/rutherford).

Thank you for your patience while we improve transit to get communities moving.

All dates are subject to change and will be communicated accordingly.

---

Contact Us:

Write to us at: [YorkRegion@metrolinx.com](mailto:YorkRegion@metrolinx.com)

Find us on Twitter @Metrolinx

Visit the website: [www.metrolinx.com/rutherford](http://www.metrolinx.com/rutherford)

Disponible en français