

Road Closures for Utilities Installaton - Finch Ave. W. at Damascus Dr./Kiskadee Dr.(Future Westmore stop)

May 12-13 and May 25-27, 2021

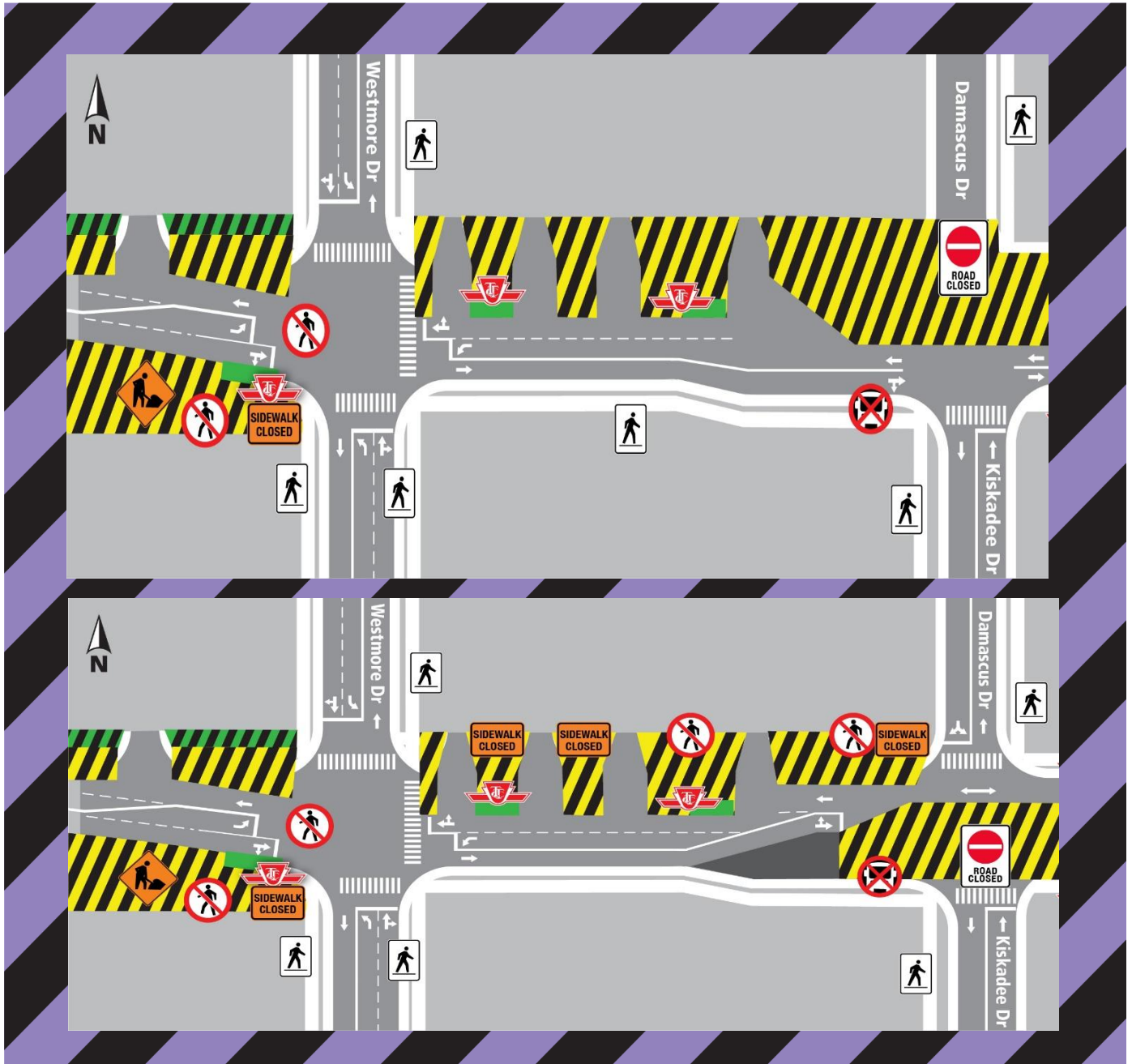

What?

As part of the preparatory works for the Finch West Light Rail Transit (LRT) line, crews have been relocating utilities in the vicinity of Finch Ave. W. and Hwy. 27.

Crews will now install a storm sewer at the intersection of Finch Ave. W. and Kiskadee Dr./ Damascus Dr.

To safely perform the work, Finch Ave. W. and Kiskadee Dr/ Damascus Dr. intersection will be closed as shown above. Kiskadee Dr. will close first at Finch Ave. W first. Once it is re -opened Damascus Dr, will close at Finch Ave. W. Both closures will not happen at the same time. The work will be done in two stages:

- May 12 - May 13, 2021 Kiskadee Drive.
- May 25 - May 27, 2021 Damascus Drive.

Finch Ave.W will be reduced to one lane at the intersection. The closure is required to protect workers and allow for deep excavation at the median area. There will be a Paid Duty Office, flaggers and a Portable Variable Message

WORK HOURS:

- Wednesday, May 12, 2021 at 7 am until Thursday, May 13, 2021 at 5 pm, approximately.
- Tuesday, May 25, 2021 at 7 am until Thursday, May 27, 2021 at 5 pm, approximately
- Kiskadee Dr. is anticipated to be closed at Finch Ave. W. from Wednesday, May 12, 2021 to Thursday, May 13, 2021, approximately.
- Damascus Dr. is anticipated to be closed at Finch Ave. W. from Tuesday, May 25 to Thursday, May 27, 2021, approximately.
- Work may be rescheduled due to weather conditions or unforeseen circumstances.

WHAT TO EXPECT

- Heavy trucks and equipment in the area.
- Due to the nature of this work, at times there will be noise, dust and vibration around the work area.
- Expect traffic delays near work zones.

TRAFFIC AND PEDESTRIAN DETAILS (SEE MAP ABOVE):

- Kiskadee Dr. will close at Finch Ave. W., starting on May 12, 2021, for two days, approx.
- Once Kiskadee Dr. is re-opened, Damascus Dr. will close at Finch Ave. W., for three days, approximately.
- Silverstone Dr. and John Garland Blvd. will provide access to Damascus Dr. and Kiskadee Dr. during these closures.
- Access to businesses will be maintained, unless otherwise communicated.
- Please allow extra time for your journey.
- Please take extra care when navigating near work zones, and always make eye contact with the driver.

Virtual Hours of Operation:
Monday- Friday, 9:00 a.m. to 5:00 p.m.
In person- by appointment.
Tel: 416-202-6500

Cet avis de travaux de construction est disponible en français sur demande. Si vous êtes intéressé, veuillez envoyer un courriel à TorontoWest@metrolinx.com

Contact Us:

Write to us at: TorontoWest@metrolinx.com
Find us on Twitter @FinchWestLRT
Visit the website: www.metrolinx.com/finchwestlrt

- TTC bus stops will be closed or relocated away from work zones, as needed.
- Relocation of bus stops is done in consultation with TTC.
- Access to TTC will be maintained at all times.
- Please visit www.ttc.ca for more information

Virtual Hours of Operation:
Monday- Friday, 9:00 a.m. to 5:00 p.m.
In person- by appointment.
Tel: 416-202-6500

Cet avis de travaux de construction est disponible en français sur demande. Si vous êtes intéressé, veuillez envoyer un courriel à TorontoWest@metrolinx.com

Contact Us:

Write to us at: TorontoWest@metrolinx.com
Find us on Twitter [@FinchWestLRT](https://twitter.com/FinchWestLRT)
Visit the website: www.metrolinx.com/finchwestlrt